



TLSD Platform Updates

Educating Georgia's Future

September 2021

Welcome

Greetings!

Since joining GaDOE in January, I have witnessed the hard work that districts have done to support the growth of teachers and leaders through the evaluation system. Even with continuing challenges, the priorities that have been established to ensure teachers and leaders receive valuable feedback and are provided both growth and recognition opportunities are evident in the large percentage of districts recording TKES and LKES progress in the platform. Even though use of the platform has been optional, the participation rate by district reveals the value that is placed in the importance of consistent record-keeping. As summative scores and TEM/LEM were not calculated for 2020-2021 and will not be calculated at the end of this school year, the opportunity is present to utilize TKES and LKES as a mechanism for professional growth. As described in the FAQs for 2021-2022, orientation, self-assessment, conferences and observations are a requirement for all districts. Even though the platform is not required for recording results and progress, we encourage you to take advantage of the capability the platform affords to maintain a longitudinal account of your teachers' and leaders' growth and performance.

We wish you a prosperous, safe year. If we can support you in the implementation of the TKES and LKES process, please reach out.

Sincerely,

Laine K. Reichert

Please see the guidance [on TLSD webpage](#) and [FAQ LINK](#) for further details concerning the 2021-2022 TKES/LKES evaluation requirements. If you have any questions, please contact Laine Reichert, Laine.Reichert@doe.k12.ga.us



@georgiadeptofed







www.gadoe.org

Step Highlight

Superintendent Assurances

Superintendents should sign off at the beginning of the year on the Superintendent Assurances. This sign off indicates that the assurances have been reviewed and what steps need to be taken to prepare for the end of year sign off.

TKES & LKES Status: What should my Teacher/Leader plans look like at the end of September?

TKES Plan Checklist	LKES Plan Checklist
Orientation 	Orientation & Evaluation Selection 
PSC Professional Learning Goal/Plan 	PSC Professional Learning Goal/Plan 
Self-Assessment and Pre-Evaluation Conference 	Self-Assessment and Pre-Evaluation Conference 

Quick Guide Videos:

- ◇ [Running the Evaluation Detail Status Report](#)
- ◇ [Completing TKES/LKES PSC Goals](#)
- ◇ [Reopening a Container](#)
- ◇ [Assigning AP's as Evaluators](#)
- ◇ [Selecting a LKES Evaluator](#)

Self-Assessment & Pre-Evaluation Conference

Reflecting on professional practice is an important step in the TAPS process. Teachers will complete a Self-Assessment prior to the Pre-Evaluation Conference. The ten Performance Standards will be used to determine professional strengths and areas for growth. The Self-assessment, located on the GaDOE TLSD Electronic Platform, will be available to both the teacher and the school evaluator for review and professional growth planning. This information should be used to inform Professional Growth Goal/Plan(s).

HINTS

1. Self-Assessments must be shared and finalized.



Self-Assessment & Pre-Evaluation Conference

2. Both the Evaluator and the Leader/Teacher must sign off on the Pre-Evaluation conference before there is a green icon.

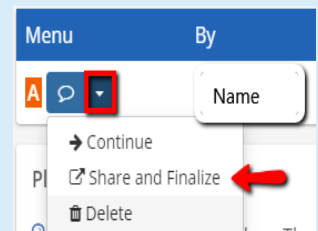

Training Videos :

- ◇ [Completing the Self-Assessment](#)
- ◇ [Analyzing Self-Assessment Data](#)
- ◇ [Pre-Evaluation Conference Sign- Off](#)